

# ELEKTRA™

— health + —



ecofriendly



## INSTRUCTION MANUAL

**ULTRASONIC**  
**COOL / WARM**  
**STEAM HUMIDIFIER**



**Read these instructions before use and keep them safe. If you pass the appliance on, pass on the instructions too. Remove all packaging, but keep it until you are satisfied.**

**IMPORTANT SAFETY INSTRUCTIONS:**

When using an electrical appliance, basic precautions should always be followed, including the following: Read all instruction before using this appliance.

**DANGER -To reduce the risk of electric shock:**

1. Always unplug this appliance from the electrical outlet immediately after using and before cleaning.
2. Do not reach for an appliance that has fallen into water. Unplug it immediately.
3. Do not use or store the appliance where it can fall or be pulled into a tub or sink. Do not place or drop into water or other liquid.

**WARNING: -To reduce the risk of burns, fire, electric shock or injury to persons:**

1. An appliance should NEVER be left unattended when plugged in. Unplug from outlet when not in use and before putting on or taking off parts or attachments.
2. DO NOT operate under a blanket or pillow. Excessive heating can occur and cause fire, electrical shock or injury.
3. Close supervision is necessary when this appliance is used by or near children, invalids or disabled persons.
4. This appliance is not intended for use by children and people with reduced physical, sensory and mental capacity.
5. Do not let children play with this appliance as there is the possibility that it could lead to serious injury and electrocution. This appliance should only be used by an adult or a person qualified to do so.
6. Use this appliance only for its intended use as described in this manual. Do not use attachments not recommended; specifically any attachments not provided with the unit.
7. Never operate this appliance if it has a damaged cord or plug, if it is not working properly, if it has been dropped or damaged, or dropped into water. Return it to the Service Center for examination and repair.
8. Do not carry this appliance by the supply cord or use the cord as a handle.
9. Keep the cord away from heated surfaces.
10. Never operate the appliance with the air openings blocked. Keep the air openings free of lint, hair and other debris.
11. Never drop or insert any object into any opening.
12. Do not attempt to plug or unplug the unit when you have wet hands.
13. Never operate on a soft surface, such as a bed or couch, where air openings may be blocked.
14. Do not use outdoors.
15. Connect the appliance to a properly grounded outlet only.
16. If the supply cord is damaged, contact the Consumer Service Centre for repair and replacement, do not attempt to repair yourself.
17. All servicing of this appliance must be performed by authorized service personnel only.
18. Keep all packaging and plastic bags out of the reach of children as these pose the risk as a choking hazard.
19. Use only normal tap water. Do not add anything to the water (e.g. salt, oils, perfumes, etc ...)

## **FOR HOUSEHOLD USE ONLY**

### **Additional Safeguards**

1. Do not try to repair the appliance yourself. Contact the approved Service Centre for examination and repair.
2. This product has been designed to operate safely when used according to the instruction guide.
3. If the electrical circuit is overloaded with other electrical appliances, your Humidifier may not operate properly. It should then be operated on a separate circuit from other appliances.

### **Additional Note**

1. Should you find after extensive use that the floor around the humidifier is wet, please turn the humidity setting down to a lower setting.
2. As the steam generated from your humidifier is not a HOT steam, it will settle rather than rise, and when the humidity is too high over long periods larger amounts of vapour will settle on the floor causing it to get wet.

## KNOW YOUR ELEKTRA HEALTH HUMIDIFIER

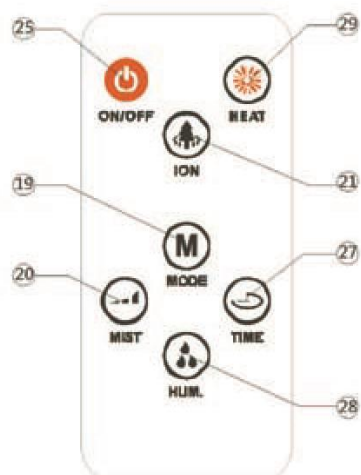
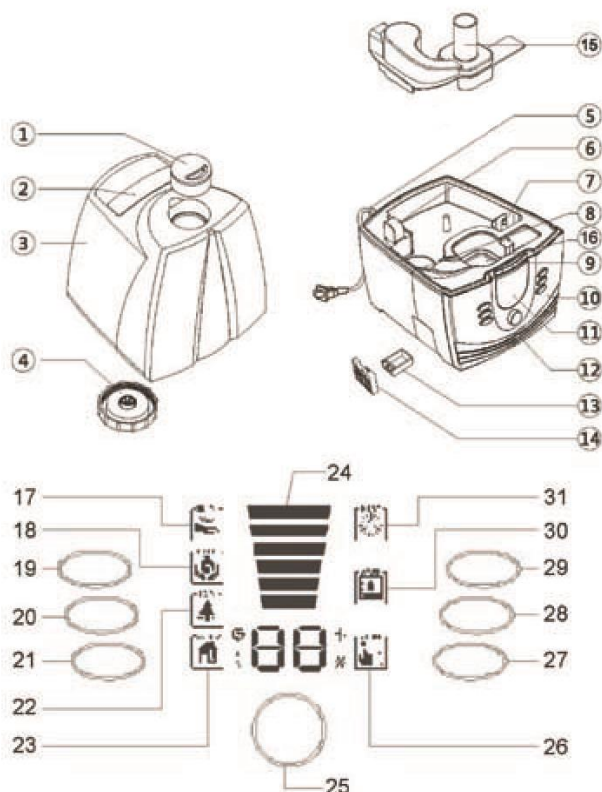

1. Nozzle
2. Tank Handle
3. Water tank
4. Tank lid
5. Power cord
6. Air outlet
7. Water protection switch
8. Transducer
9. LED board
10. Machine panel
11. LCD display
12. Ioniser generator
13. Aroma oil holder
14. Inlet grid
15. Mist funnel
16. PTC heater
17. Skin icon
18. Care icon
19. Mode
20. Mist
21. Ioniser / LED
22. Ioniser icon
23. Environmental humidity icon
24. Mist level
25. Power switch
26. Humidity icon
27. Timer
28. Humidity
29. Heat
30. Water icon
31. Heat icon

## **User Instructions**

1. Place the base of the unit on a smooth level surface.
2. Remove the water tank and unscrew the tank lid underneath the tank.
3. Pour plain cold tap water into the tank.
4. Always use ordinary tap water and never add anything to the water (e.g. salt, oils, perfumes, etc ...)
5. Ensure that you tighten the tank lid securely.
6. Place the tank onto the base.
7. Place the nozzle into the recess on top of the tank, and direct it away from walls and furniture.
8. Plug the appliance into the power outlet and depress the power switch.
9. The screen will illuminate.

## **Different Functions**

1. The MODE button (19) will allow you to select from the HEALTH / SKIN CARE modes.
  - HEALTH: The humidity level will automatically be set at 60% relative humidity.
  - SKIN CARE: The humidity level will be controlled at approximately 70% relative humidity.
2. The MIST button (20) allows you to set 3 different levels of mist output intensity.
3. The ION/LED button (21) has two features.
  - (i) LED light – the light can be used with or without the ioniser function. To use the light only press the button once. If you wish to use the ioniser and LED light push the button three times.
  - (ii) Ioniser – the ioniser can be used with or without the LED light. To use the ioniser only, press the button twice. If you wish to use the ioniser and the LED light press the button three times.
  - (iii) To turn all off, push the button four times.
  - (iv) When the ionizer is functioning the ionizer indicator light will illuminate (22).
4. To select warm steam simply press the HEAT button (29). Should you wish to turn off the warm steam function press the button a second time.
5. Should you select the warm steam setting it may take a few minutes before warm steam is emitted.
6. You may set the humidity level to your needs, by using the HUMIDITY button (28). The available range is 40 – 80% room humidity.
7. The TIMER button (27) allows you to set the timer ranging from 1 hour to 16 hours.
8. When the humidifier runs out of water, the appliance will automatically switch off the steam production mechanism.
9. The steam production time and emission quantity may vary depending on the water hardness.
10. Remote Control – The remote control functions in the same manner as described above for the humidifier.

## **Aroma Therapy**

Should you wish to include an essential oil for health reasons, or just to enhance the atmosphere:

1. Remove the Aroma oil holder (13).
2. Fill with Aroma oil / Essential oil.
3. Replace the Aroma oil holder.

## Care and Maintenance

1. Switch the appliance off and unplug it.
2. Wipe the body of the appliance off with a soft damp cloth. If necessary use a little washing-up liquid.
3. Rinse the water tank with clean water after each use. To dry for storage, wipe with a soft clean cloth.
4. Do not use detergents to clean any part of the unit that normally contains water. Detergents can interfere with the performance of the unit.
5. Do not immerse the humidifier in water or any other liquid.
6. Do not use harsh or abrasive cleaning agents or solvents.
7. Keep the transducer clean by brushing with a soft brush.
8. Do not store with water in the tank.
9. When cleaning the base, beware not to get water in the air outlet.

PROBLEM	CAUSE	REPAIR
1. The Humidifier does not turn on. There is no mist output and no air emission	Not connected to the power supply	Connect the humidifier to the power supply
	Humidifier not on.	Switch on the unit
2. Power on, air emission, but no mist output	No water in the water tank	Fill tank with water
3. Malodorous mist	New humidifier	Open water tank, and leave to air for 12 hours
	Dirty water used or old water in the water tank	Clean the water tank, fill with clean water
4. Power on, no air emission and no mist output	Too much water in the base	Empty the flume, and tighten the tank lid
5. Poor mist emission	Dirty ultrasonic transducer	Clean the transducer
	Dirty water used or old water in the water tank	Clean the water tank, fill with clean water
6. Abnormal noise / Noisy	Low water level in the tank.	Fill water tank.
	Resonance from table-board	Place on a stable level surface.

## After Sales Service

The appliance is not user-serviceable. If it is not working properly check:

1. You have followed the instructions properly.
2. The outlet supply is switched on.
3. The main supply fuse/circuit breaker has not blown/tripped.

If the appliance still does not work, contact the Service Centre.

TEL: 011 393 1328  
FAX: 011 393 1501  
EMAIL: [technical@sp-africa.com](mailto:technical@sp-africa.com)

**Guarantee**

Any defect affecting the functionality of the appliance which becomes apparent within one (1) year of its purchase, will be corrected by free repair or replacement, provided that the appliance has been used and maintained in accordance with the instructions, and has not been altered/modified, abused or misused in anyway, and is accompanied with a Proof of Purchase to validate the age of the appliance.

**Specification**

220 - 240V 50Hz 38 - 90W

**The Environment**

This appliance is rated at an operating input of 38 – 90 watts.



Please consider the environment when disposing of packaging. Recycle wherever possible. When you want to dispose of this appliance please do so responsibly, or contact us to assist with the disposal, or disposal advice.



**140 North Reef Road  
Elandsfontein  
South Africa  
1401**

**Tel: 011 393 – 1328  
Fax: 011 393 – 1501  
[www.sp-africa.com](http://www.sp-africa.com)**