

# ELEKTRA™

— *comfort* —



## INSTRUCTION MANUAL MIST FAN



What Have  
We Done  
For You Today?

**Read these instructions before use and keep them safe. If you pass the appliance on, pass on the instructions too. Remove all packaging, but keep it until you are satisfied.**

## **Important Safeguards**

Before connecting the appliance check that the voltage indicated on the rating plate corresponds to the mains voltage in your country.

When using electrical appliances basic safety precautions should always be followed. Please read the following carefully before use:

1. After unpacking, make sure that there are no visible signs of damage.
2. This appliance must only be used as a fan as indicated in the instructions. Any other use is to be considered hazardous. Selian Agencies C.C. and any of its associate companies cannot be held responsible for any damage or injury that may occur due to improper and incorrect use.
3. Please follow assembly instructions carefully.
4. Only turn on the appliance once you are completely certain that it has been assembled correctly, so as to avoid injury.
5. Do not use with wet hands or feet, or while your body is wet.
6. Do not use the Fan if it is wet.
7. Keep the Fan away from water. Do not use the Fan near water.
8. Should the Fan fall into water, first turn the power supply off and then remove the plug from the wall socket. Remove the Fan from the water, and contact the Consumer Service Centre to inspect your Fan before you use it again.
9. Do not pull the appliance or the power cord to remove the plug from the socket.
10. Before cleaning the appliance, disconnect it from the mains by removing the plug. Follow the cleaning instructions carefully.

11. Please follow cleaning instructions carefully so as to avoid injury or damage.
12. Should the Fan or protection fuse fail to work properly, turn off the appliance and unplug it from the power outlet. Contact the Consumer Service Centre for examination and repair.
13. Always unplug the appliance immediately after use.
14. Check the cord regularly for wear or damage, particularly where the cord enters the appliance and the plug.
15. During use, ensure that the power cord is completely unwound.
16. Close supervision is necessary when this appliance is used by or near children and invalids.
17. Keep the air intake cover free of dust or fluff.
18. Do not allow the air inlet to become blocked or even partially blocked. This may cause the Fan to overheat. If it does overheat, the safety cut-out will cause the Fan to switch off and remain inoperable until the unit has sufficiently cooled down. In this event, switch off the appliance, unplug it and let it cool down. Remove any blockage to the air inlet or outlet before resuming use. If the Fan should cut out again, even when there is no blockage, contact the approved Service Centre for examination and repair.
19. Do not cover the Fan or place anything over it.
20. Do not place anything through the grills or into the Fan.
21. Do not use the Fan if it is not properly and completely assembled.
22. Do not use the Fan without the mesh guards, as this could lead to injury.
23. Do not use the Fan within 1 meter of any other electrical or electronic appliance (e.g. TV, computer,..) as it may cause interference.
24. The installation of a residual current operated protective device with a nominal trip current of 30mA offers additional protection. Contact your electrician.

## **Household use only**

### **Additional Safeguards**

1. Do not try to repair the appliance yourself. Contact the approved Service Centre for examination and repair.
2. This product has been designed to operate safely when used according to the instruction guide.
3. If the electrical circuit is overloaded with other electrical appliances, your Fan may not operate properly. It should then be operated on a separate circuit from other appliances.

# Know your Elektra Cool Mist Fan

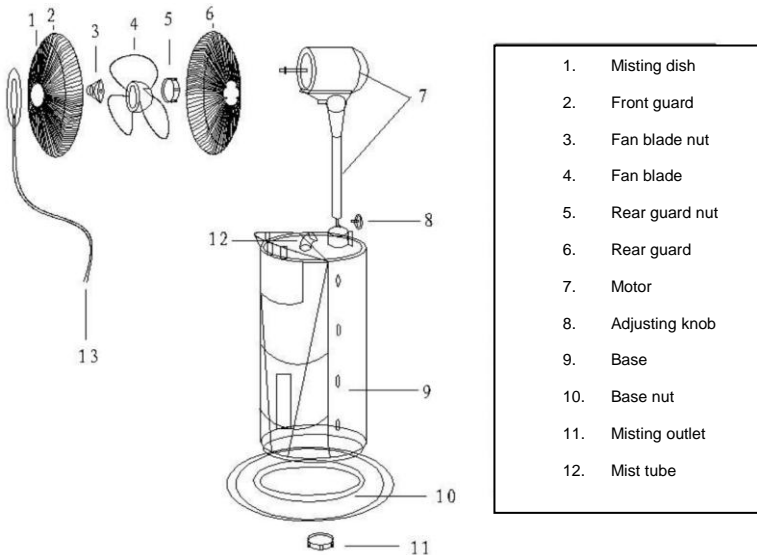

## Assembly and Installation

1. Open the packaging and ensure all the parts are correct.
2. Assemble the Chassis components.
3. Place the Main Body onto the assembled Chassis.
4. Insert the Stanchion into the opening of the top of the Main Body and secure using the Stanchion Screw
5. Affix the Motor to the Support Pole and connect to the top of the Stanchion.
6. Place Back Guard onto Motor and secure with the Rear Guard Screw.
7. Place the Fan Blade and secure with the Fan Blade Screw, by turning in an anti-clockwise direction.
8. Place the Hoop Net over the Front Guard, and connect to the Back Guard.
9. Tighten the Hoop Net.

## Water Tank

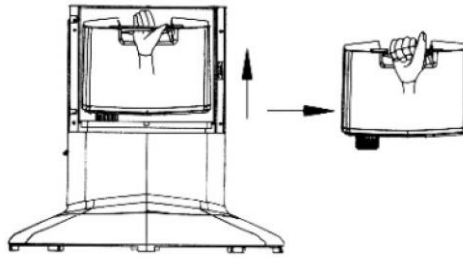

Take water tank out horizontally

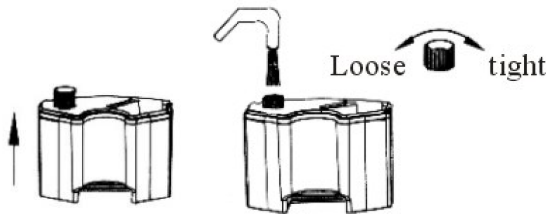

## Humidifier

Assemble and use the humidifier as follows:

1. Open the Water Tank compartment and remove the tank.
2. Unscrew the Water Tank Cap and fill it with cold fresh tap water.
3. Screw the Water Tank Cap back on and place the tank into the Water Tank compartment.
4. Connect the Mist Tube. Connect the power supply and press "Mist Button". The mist will appear in 2-5 seconds.
5. The light on the Function Display will be blue when working. The light will turn red when the water tank is empty.

## Remote Control



- OFF – The OFF button turns the fan unit off.
- ON/SPEED - Turns the fan on, and allows you to increase/decrease the fan speed.
- SWING - Turns on or off the oscillating function.
- TIMER - Operation time can be set as follows: 0.5/1/2/4 hours. The remaining time will appear on the LED panel.
- MODE - Allows you to set the type of airflow.  
Normal/Nature/Sleep.
- MIST - Activates the humidifier, and produces mist.

## **Instructions for Cleaning**

Should you need to clean the Fan :

- Unplug the Fan from the power outlet.
- Wipe it down with a damp cloth and a small amount of non-abrasive cleaning agent.
- Never get the Fan wet.
- Do not use it if it is wet.
- Clean the air inlet and outlet regularly. You may use a vacuum cleaner.

## **Storage Instructions**

Your Fan should be stored in a cool, dry place.

## **After Sales Service**

Your Elektra Comfort Fan is not user-serviceable.

If the Fan does not turn on, check to see that:

1. You have followed the instructions properly.
2. The outlet supply is switched on.
3. The main supply fuse/circuit breaker has not blown/tripped.

If the appliance still does not work, contact the Service Centre.

If the power supply cord or any wiring is damaged, or the Fan has been misused or damaged, stop use immediately and contact the Service Centre.

TEL: 011 393 1328 FAX: 011 393 1501 EMAIL: <a href="mailto:technical@sp-africa.com">technical@sp-africa.com</a>
---

## **Guarantee**

Any defect affecting the functionality of the appliance which becomes apparent within one (1) year of its purchase, will be corrected by free repair or replacement, provided that the appliance has been used and maintained in accordance with the instructions, and has not been altered, abused or misused in anyway, and is accompanied with a Proof of Purchase to validate the age of the appliance.



## **Specifications**

220-240V 50Hz 100W

## **The Environment**

This appliance is rated at an operating input of 100 watts.

**eco**friendly

Please consider the environment when disposing of packaging.

Recycle wherever possible.

When you want to dispose of this appliance please do so responsibly, or contact us to assist with the disposal, or disposal advice.



**SELIAN AGENCIES C.C.**  
**8 Palala Street, Protec Park, Terenure Ext. 42,**  
**Kempton Park, South Africa, 1610**  
**Tel: 011 393 – 1328**  
**Fax: 011 393 – 1501**  
**[www.sp-africa.com](http://www.sp-africa.com)**